

**NOTES:**

1. 1,000 lbs. WORKING LOAD IN AXIAL DIRECTION.
2. ASSEMBLY SHOWN IS 20" & 22" HIGH MODELS FOR STANDARD SLAB THICKNESS OF 6" MIN.
3. ASSEMBLY SHOWN IS BOLT THROUGH VARIOUS WALL THICKNESS.

**IMPORTANT:**

1. THE SAFETY ANCHOR HAS BEEN DESIGNED TO ENSURE THAT FRACTURE OR DETACHMENT DOES NOT OCCUR WITH A 5,000 lbs. (22.2 KN) LOAD.
2. IT IS THE RESPONSIBILITY OF THE STRUCTURAL ENGINEER FOR THE OVERALL PROJECT TO ENSURE THAT THE STRUCTURE ON WHICH THE SAFETY EQUIPMENT BY PRO-BEL IS INSTALLED, IS REINFORCED TO WITHSTAND THE LOADS INDICATED ON THIS DRAWING.

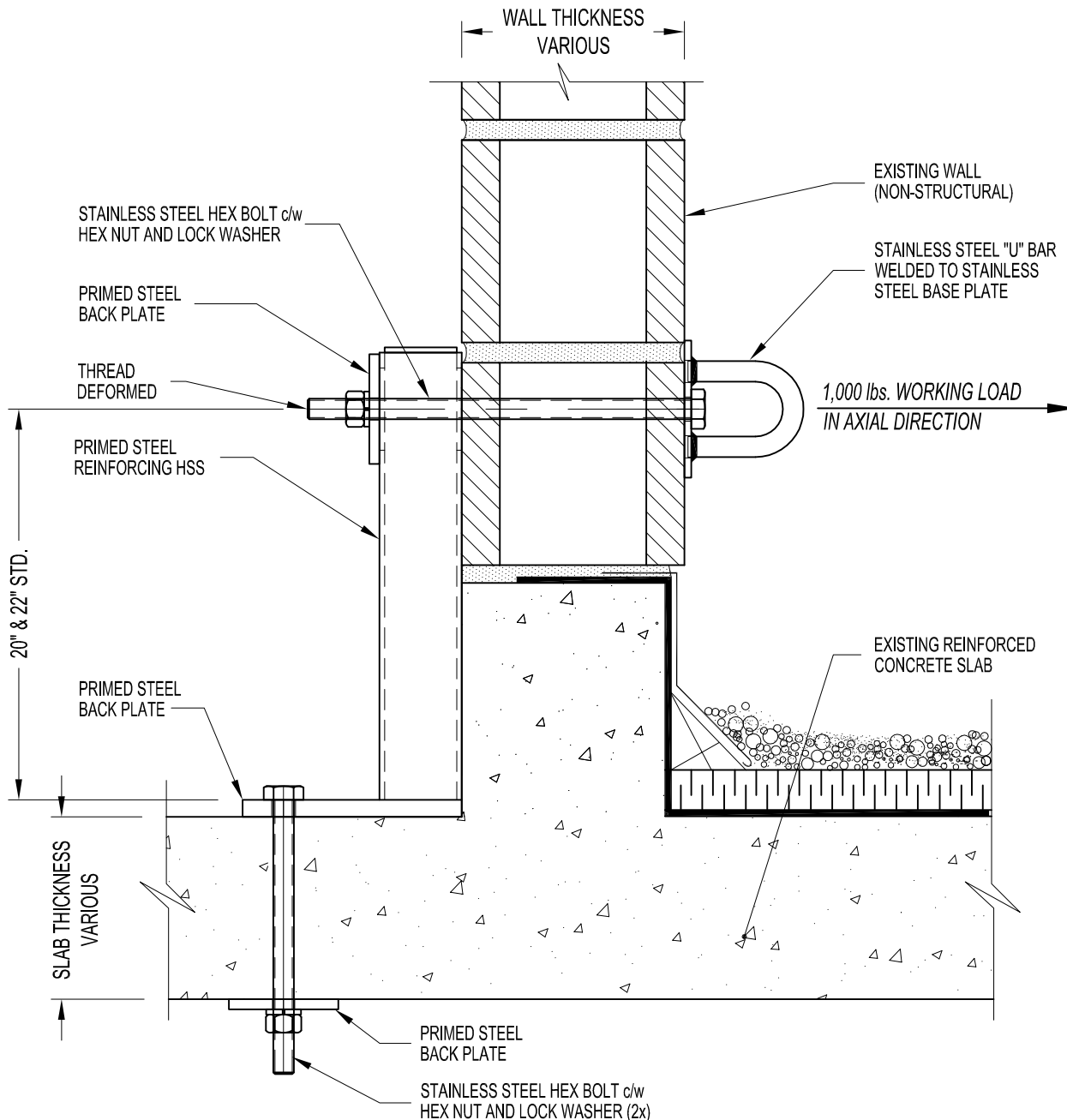

**PB93SG-B2S: REINFORCED THROUGH BOLTED ANCHOR (BOLT THRU SLAB - 2 BOLTS)**